

QUICK START GUIDE

Follow 1 2 3 to set up your soundbar

See Next Page for
SETTING UP YOUR HOME THEATER

THANKS FOR SUPPORTING US

RAYMAN CHENG, CEO OF  Nakamichi®

Nakamichi fans voted us as

#1 RATED SOUND BAR COMPANY IN USA*



*Based on  and  customer reviews for true discrete surround soundbars.

1 BEST CONNECTIONS





HDMI **HDMI 2.0** HIGH-DEFINITION MULTIMEDIA INTERFACE

OPTICAL



Always use HDMI 2.0 high speed cable or Optical cable for best audio quality

2 BEST AUDIO



Press INFO  button on remote to see the source audio format on the soundbar's LED display:
"DOLBY ATMOS TRUEHD", "DOLBY ATMOS D PLUS" (Dolby Digital Plus), "DTS X", "DTS" or "PCM 2.0"
(Refer to user manual for complete list of audio formats supported)

3 BEST SURROUND



DIRECT

D



Recommended Settings
For Dolby/PCM audio:
DOLBY SURR = All-Channel Surround + Height
DOLBY UPMIX = All-Channel Surround
For DTS audio:
NEURAL X = All-Channel Surround

Set DIRECT to recommended settings above using remote for best surround experience

CUSTOMER HAPPINESS COMMITMENT



 support@nakamichi-usa.com

 (415) 805 6913

Weekdays 10am - 7pm PST; Weekend 10am - 5pm PST

SETTING UP YOUR HOME THEATER

1A SOUNDBAR & SUBWOOFER PLACEMENT

Recommended speaker placement with optimal distance. Actual distance can vary based on room layout.

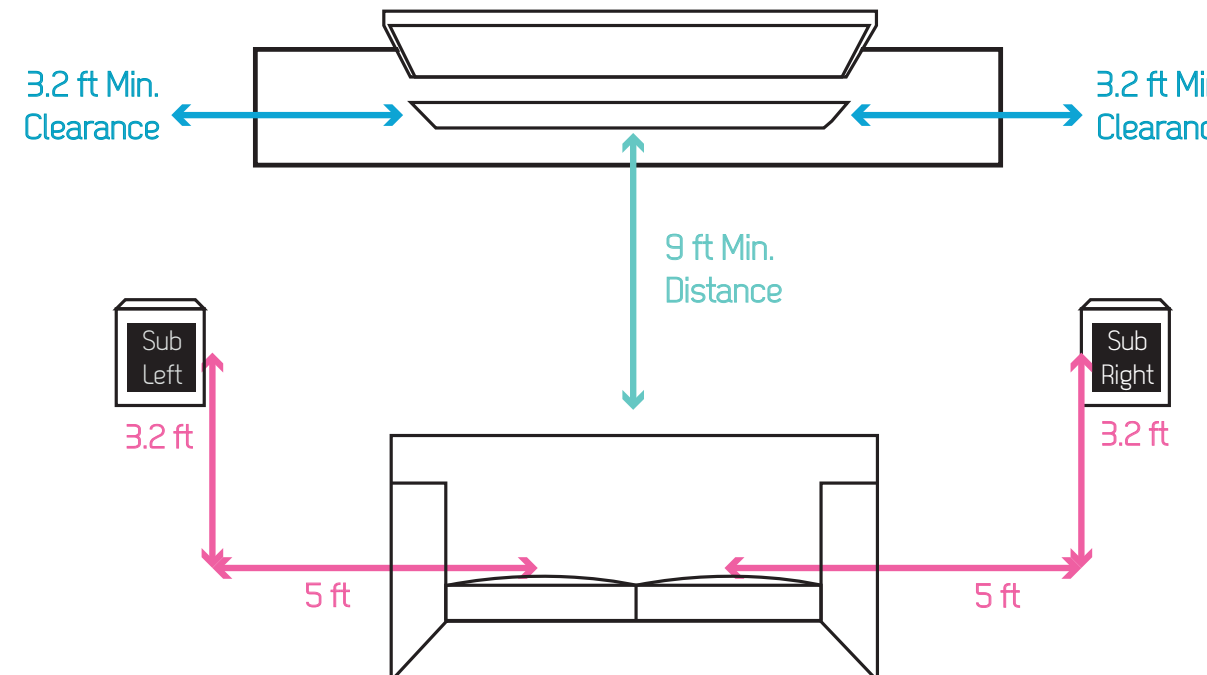

1B SURROUND SPEAKER PLACEMENT

The bottom speaker driver of the surround speakers should be at ear level for optimal performance.

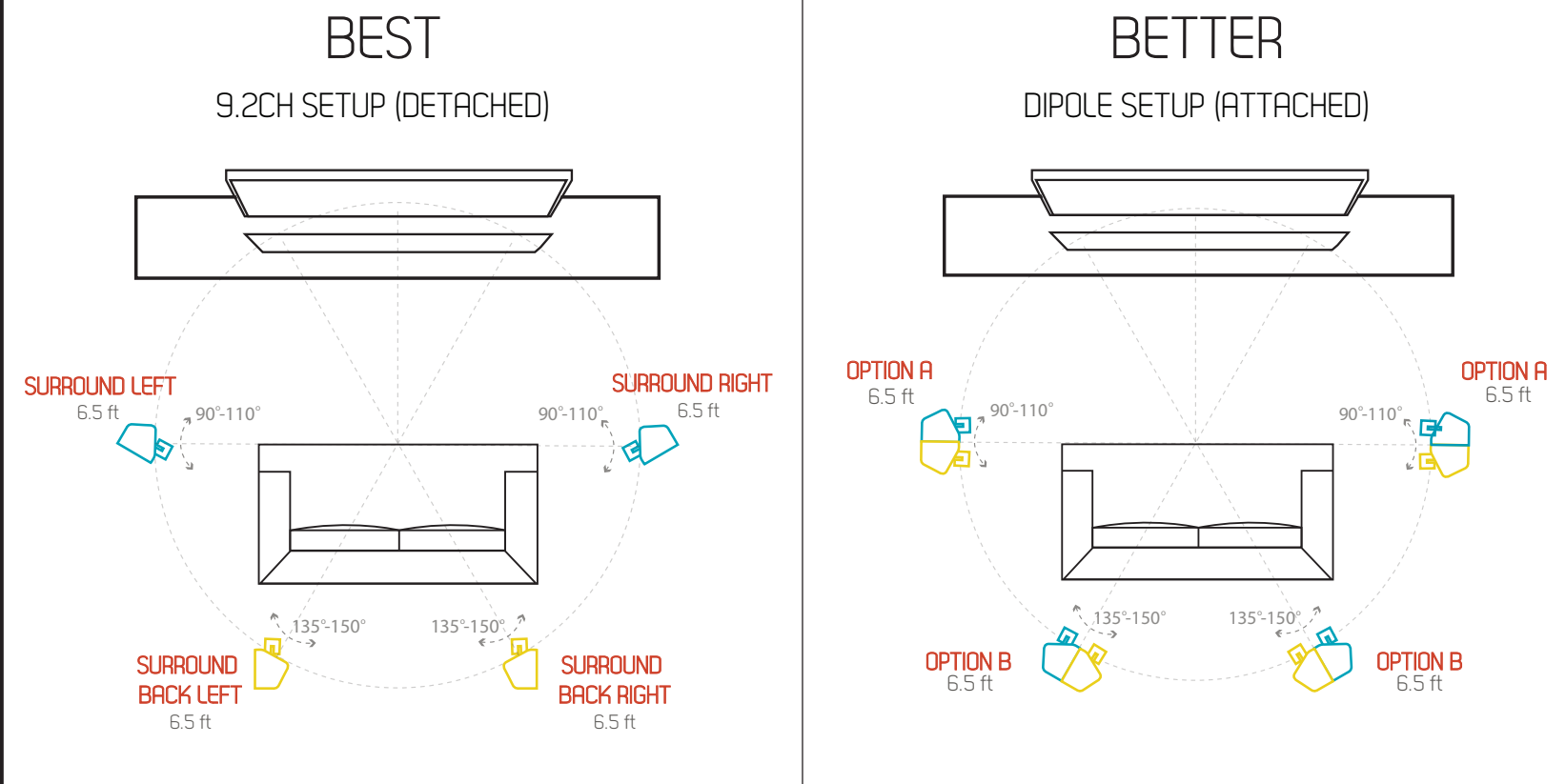

For more surround speaker placement options, visit nakamichi-usa.com/sse-placement

NOTE: Illustration is not to scale. Speaker stands are not included. **Dipole Setup:** Refer to user manual for how to attach the surround speakers together. Flip the switch at the back of the Surround Back speakers from 9.2CH to DIPOLE.

2 CONNECTING SURROUND SPEAKERS TO SUBWOOFERS

Connect surround speakers to the ports on the back panel of subwoofers

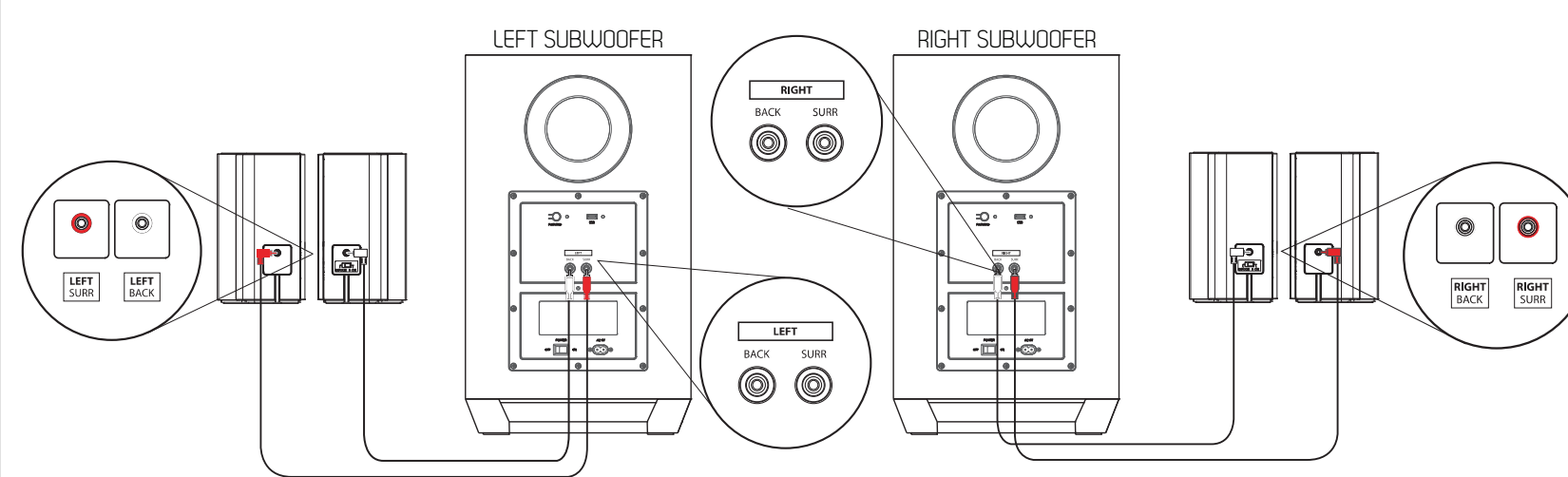

3 TURNING ON YOUR TV

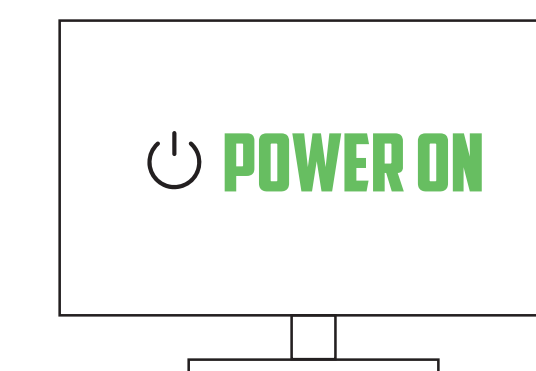

4 TURNING ON YOUR SOUNDBAR

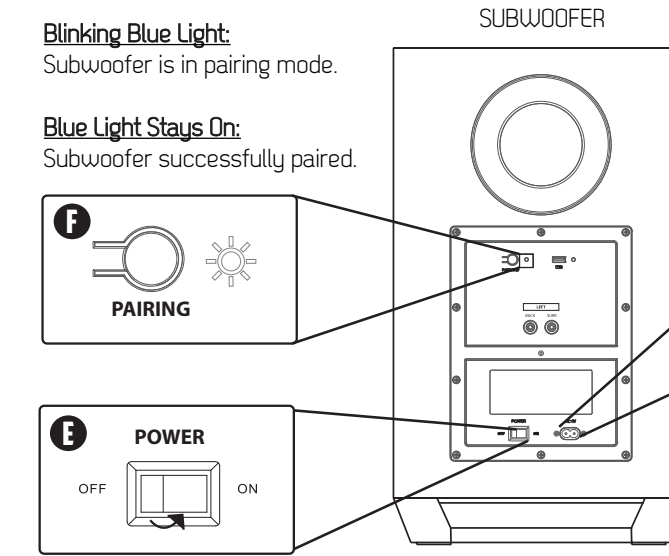
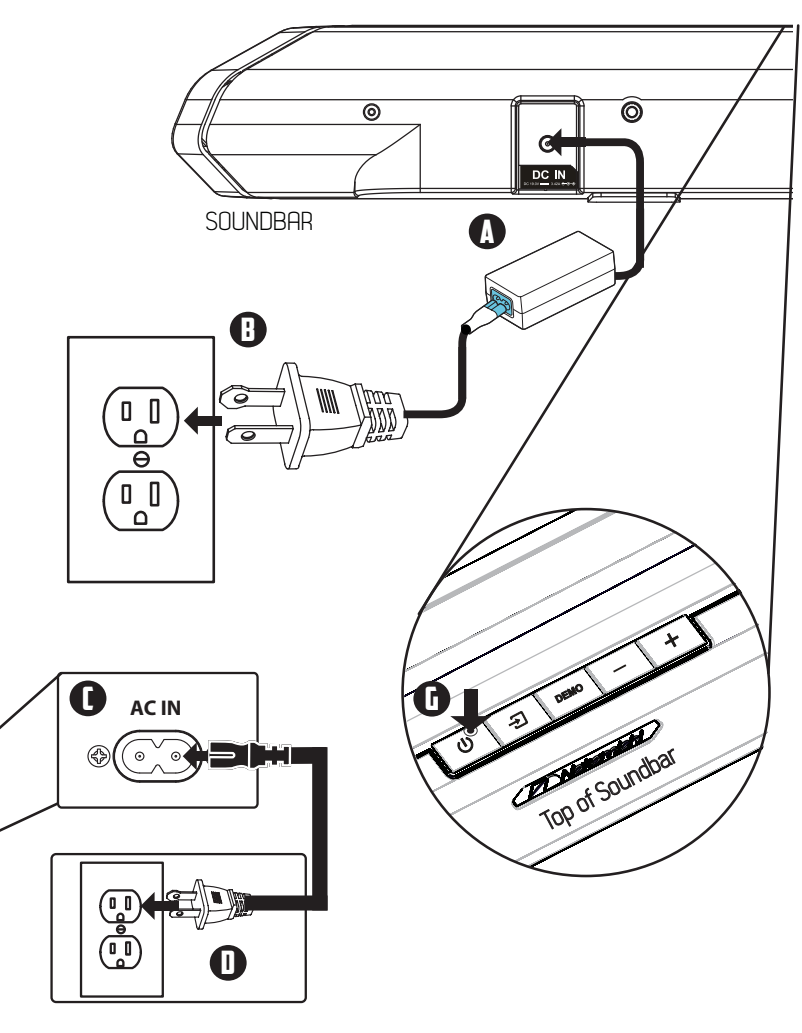

5 CONNECTING YOUR TV

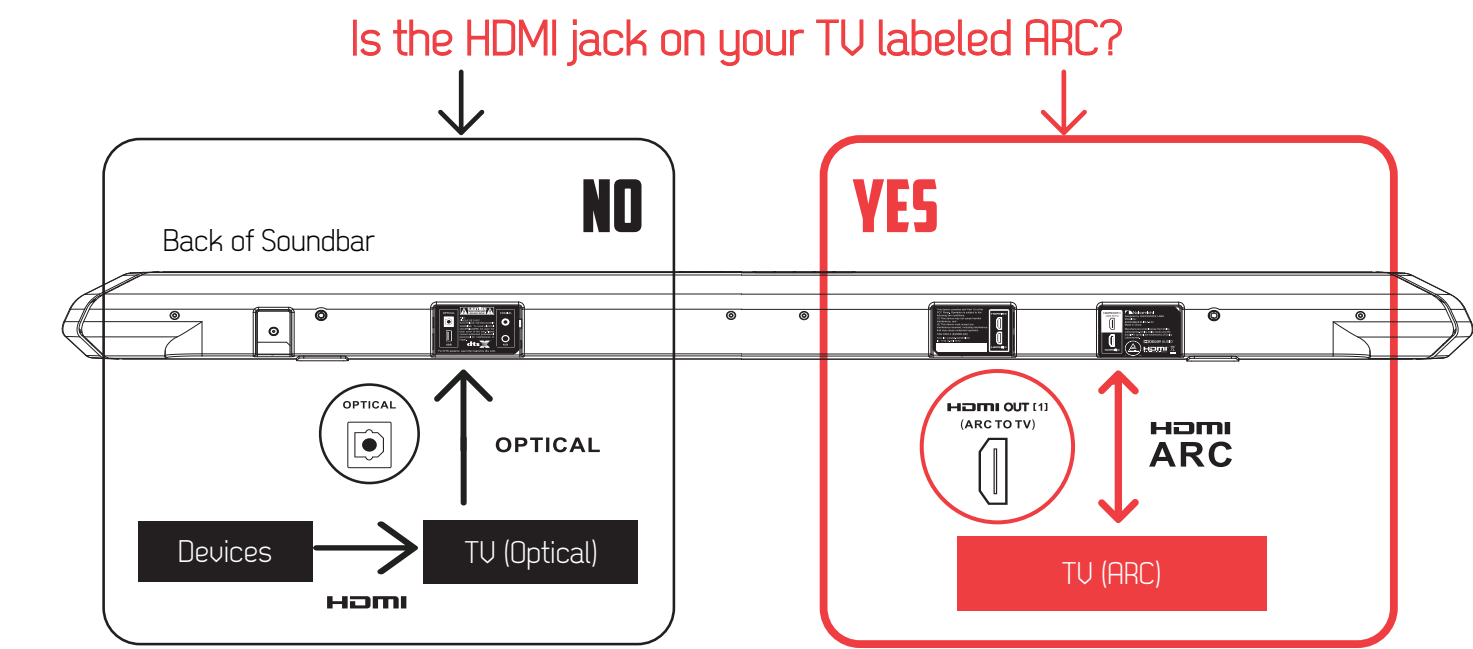

6 LISTENING TO YOUR SOUNDBAR

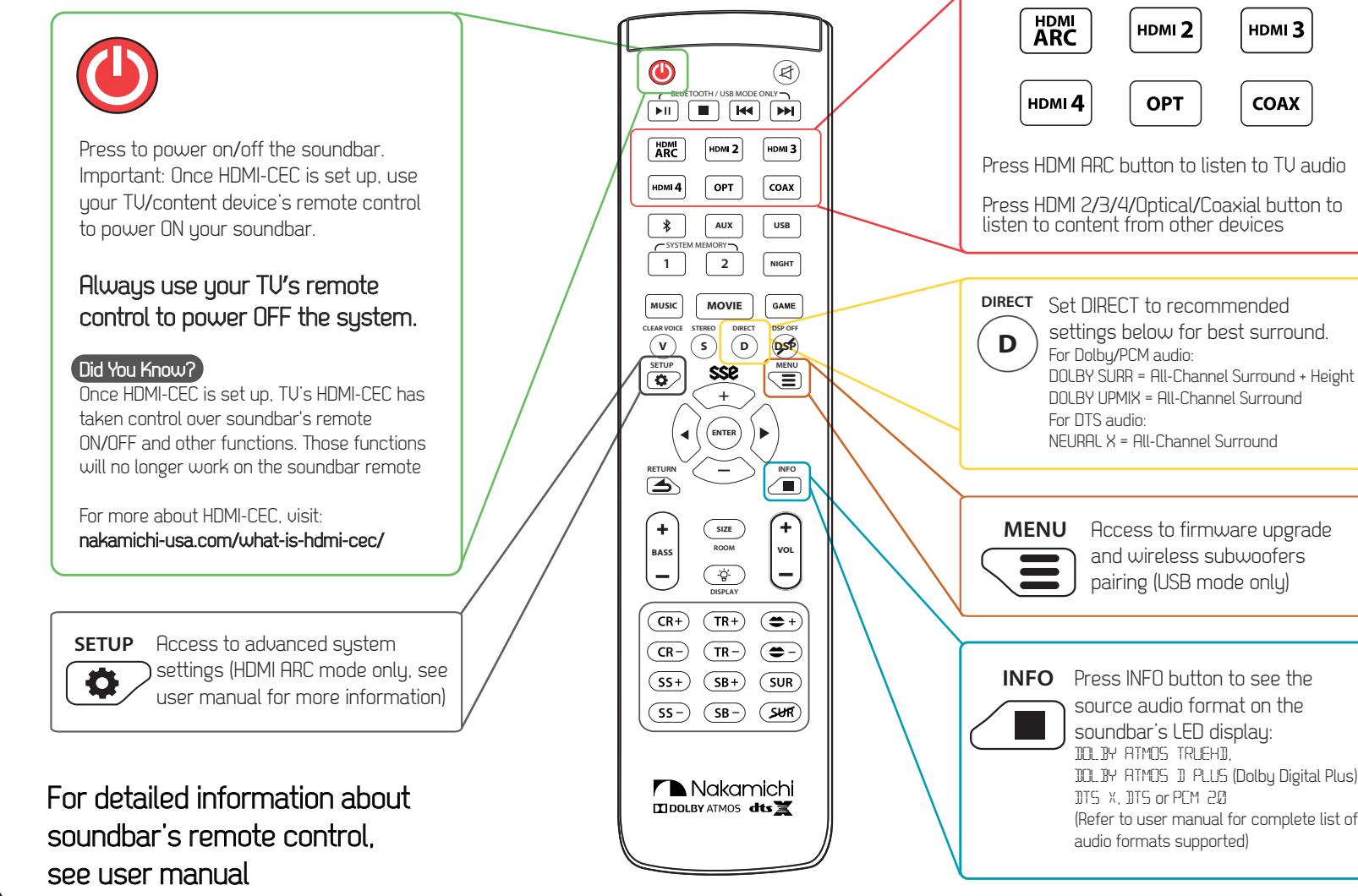

For detailed information about soundbar's remote control, see user manual

7 SETTING UP YOUR TV

Audio menu settings may vary based on year and model of TV.

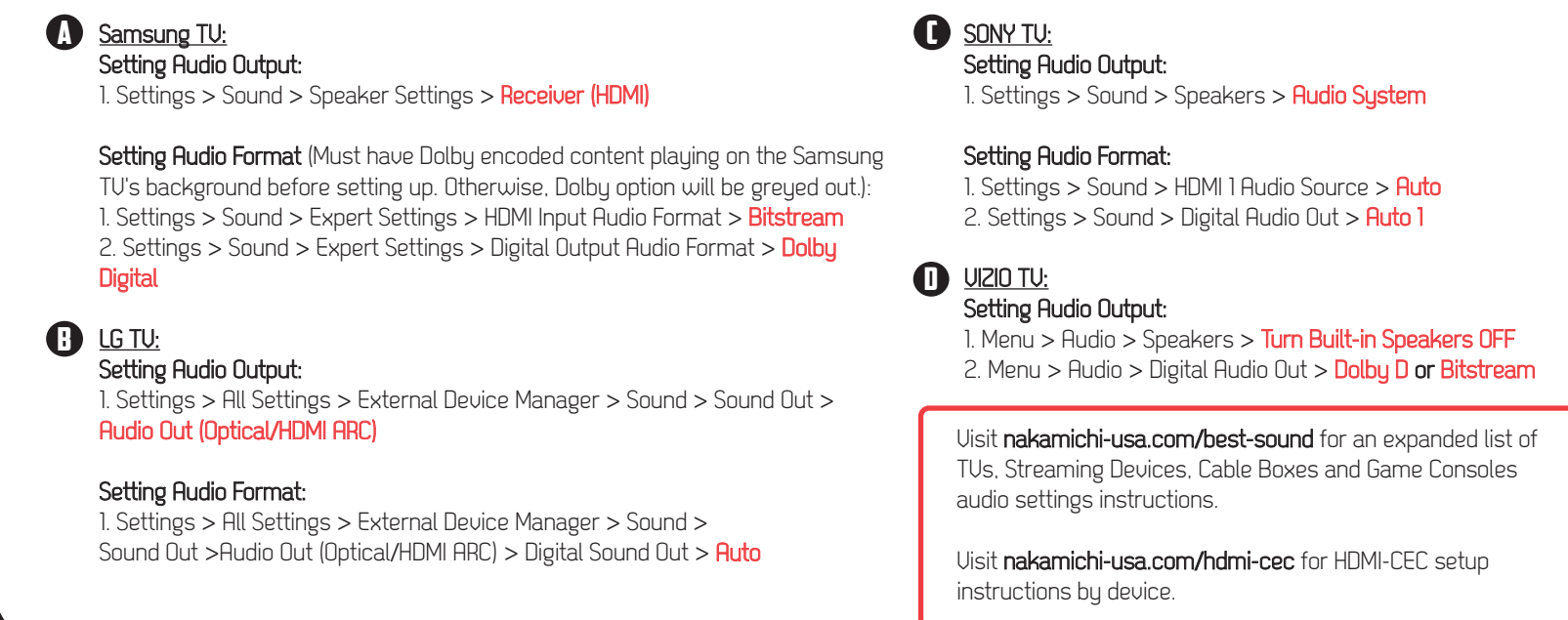

8 CONNECTING YOUR CONTENT DEVICES

Note: If you are using Optical connection option, connect all your content devices to TV.

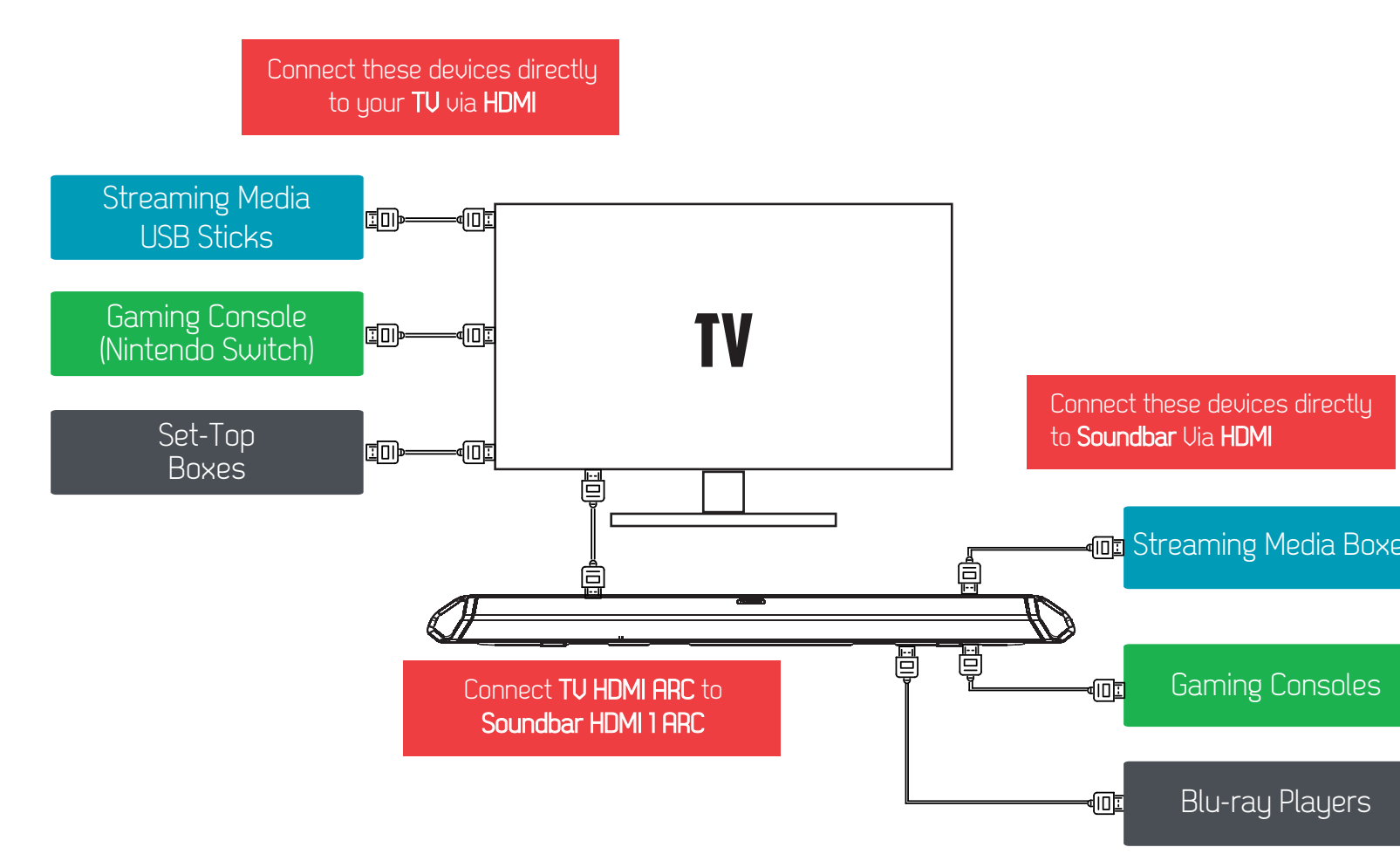

STOP

PLEASE DO NOT
RETURN THIS UNIT

ONE-STOP SUPPORT SOLUTION
www.nakamichi-usa.com/faq
CUSTOMER CARE
support@nakamichi-usa.com
(415) 805 6913
(Weekdays 10am - 7pm PST; Weekends 10am - 5pm PST)

SPEAK

TO A SHOCKWAVE
SOUNDBAR SPECIALIST

EASY TROUBLESHOOTING

- SYSTEM RESET**
- Switch to **HDMI ARC input**
 - Press the **SETUP** button
 - Toggle and select **"RESET"**
 - Press **ENTER** button
- HDMI REFRESH - ESTABLISH A NEW HDMI HANDSHAKE BETWEEN TV & SOUNDBAR**
- Unplug everything** that is connected to soundbar and TV while they are on
 - Power off** the soundbar and TV
 - Unplug it** from the AC outlet
 - Wait for 5 minutes**
 - Plug it back** into AC
 - Power on** the soundbar and TV
 - While it is on, **connect the HDMI cables** (make sure the cables are HDMI 2.0 high speed certified)
 - Configure your **Audio and HDMI-CEC settings**. See Section 7
- SUBWOOFERS AND REAR SPEAKERS REFRESH**
- Power off** the soundbar and subwoofers
 - Unplug their power cords** from the AC outlet
 - Wait for 5 minutes**
 - Plug all devices back into AC outlet**
 - Power on** all devices
 - Press and hold the button** on the **back of the subwoofers** until the **blue led light starts blinking rapidly**
 - Within 1 minute, **switch soundbar to USB mode**
 - Press and hold the DEMO button** on the soundbar until "PAIR" appears on soundbar display
 - Once pairing is completed, the **blue led light will remain solid**

For more troubleshooting or FAQs, visit
helpdesk.nakamichi-usa.com/faq

SCAN QR CODE OR VISIT
[NAKAMICHI-USA.COM/BEST-SOUND](https://nakamichi-usa.com/best-sound)
FOR COMPLETE AUDIO SETTINGS INSTRUCTIONS